

Eye Trax User Guide

For Outdoor Camera Installation



Contents

3 Chapter 1: Getting Started

- 3** What You Need
- 3** Operations and Testing
- 3** Camera Location Setup
- 4** Mounting

6 Chapter 2: Basics

- 6** Power Connection
- 6** Motion Detector
- 7** Motion Detector Settings
- 7** Aiming Camera
- 8** User Interface

10 Chapter 3: Troubleshooting

- 10** Camera is Not Sending Pictures
- 10** Camera is Sending Too Many Pictures
- 10** Motion Detection is Not Picking Up Motion

11 Chapter 4: Other Resources

WARNING: To avoid all injury, read all operating instructions in this user guide.

What You Need

To use outdoor camera, you need:

- Phillips Head Screwdriver
- Ladder
- Place to mount camera
- Computer, cellular phone, or tablet
- Internet connection to access “User Interface”

Operations and Testing

1. Before You Deploy Camera

Open the shipping box containing the camera and all components. Familiarize with all components.

2. Operate and Test

- a. Power the camera “on” and test the functionalities before you deploy the camera. (see: “User Interface” instructions)
- b. Save time in verifying camera aiming by having the pictures sent to your cellular phone for review.
- c. Be sure to power “off” your camera before you deploy it in efforts to maintain battery power.

WARNING: Allowing the battery to deplete to zero volts could result in damaging internal components. This will not be covered under warranty.

3. Deploy your Camera

You are now ready to deploy your camera. Be sure to bring all necessary tools in order to mount your camera.

Camera Location Setup

1. Identify Viewing Target

Measure the width of desired surveillance area.

2. Identify Camera Location

Eye Trax unit should be placed at $\frac{1}{2}$ the width of the viewing target.

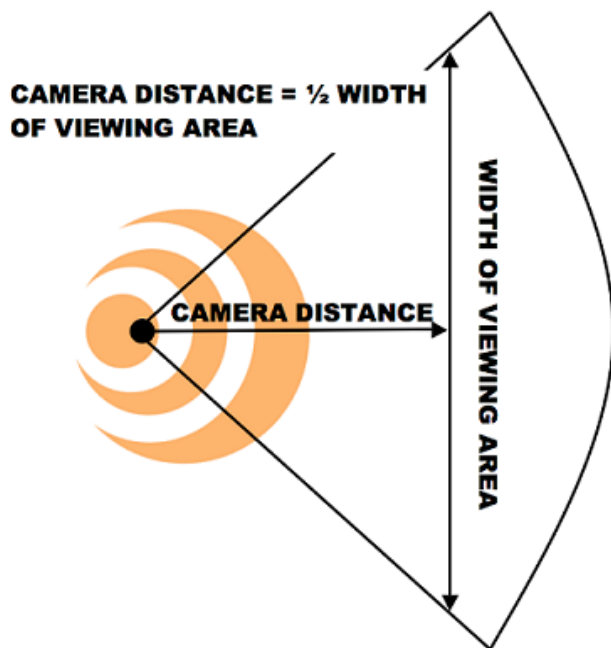

WARNING: Radio frequency signals may cause motion sensor to create a false trigger. Be sure not to point the camera in the direction of RF signal if utilizing the motion sensor.

Mounting

1. Determine Camera Mounting Height

It is recommended to mount camera at 12 feet above ground, but not exceeding 25 feet if utilizing the motion sensor.

2. Mounting Camera Bracket

Once the camera location has been established, study the area for a mounting location. If there is not a location, present a mounting pole to be installed. (see: Step 5 pole installation)

Typical Mounting Examples:



Zip Tie to Tree up to 14"
Diameter



Fence Pole with 2 1/4"
U-Bolts Diameter



4" PVC Schedule 40
Pipe with 2" Stainless
Steel Screws

3. Pole Installation Instructions (if required)

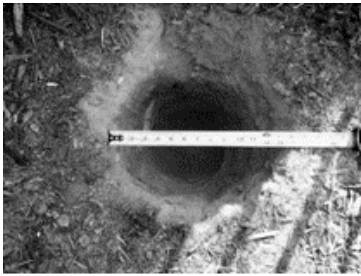

Dig Hole with 8"
Diameter

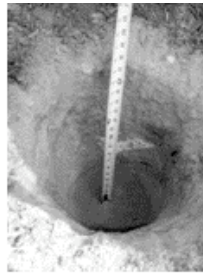

Dig Hole to a depth of
24"



Install Pole using
concrete

4. Install Mounting Bracket

Based on mounting type, mount bracket to surface using supplied hardware.

5. Install Camera to Bracket

With provided 1/4"x20 screws and Allen Wrench, install camera unit to mounting bracket.



Power Connection

1. Connect Power

- A. **110V Plugs** unit directly into power source.
- B. **Solar Panel** Installation Instructions:
 1. Install mounting bracket (see: Step 4)
 2. Mount solar panel to bracket
 3. Point the panel **SOUTH** (use Compass if available)
 4. Clear obstructions from blocking sun (full sun exposure is required)
 5. Adjust to 45 degrees or perpendicular to sun exposure
 6. Connect power wires
 7. Turn camera unit to "**ON**" position

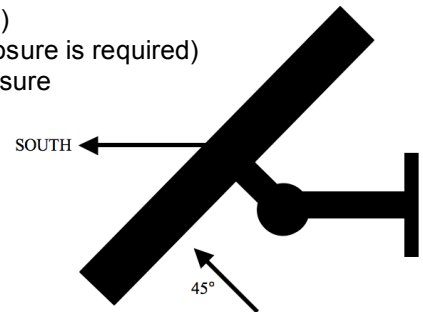

WARNING: Solar panel requires at least 6 hours of direct sunlight. Allowing the camera to be depleted of all power may cause internal damage and is not be covered under warranty.

Motion Detector

1. Adjust Motion Detector

If needed, adjust motion detector so that it is square with camera housing and pointing in the same direction of the camera lens.



Motion Detector Settings

1. Adjust Motion Detector Settings

- A. Sensitivity: 50% for climates where ambient temperature is less than 85°F
80% for climates where ambient temperature is greater than 85°F
- B. Photo: Sun and moon for 24 hour motion sensor activity.
Moon for sensor activating when sun goes down.
- C. Time: ALWAYS keep the setting on 5 seconds. Changing this will cause the motion sensor to create false triggers.

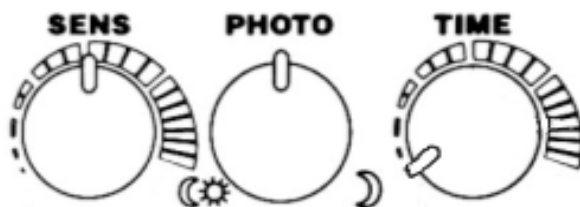

Camera Aiming

1. Aim Camera

Aim camera by adjusting mounting bracket swivel screw.

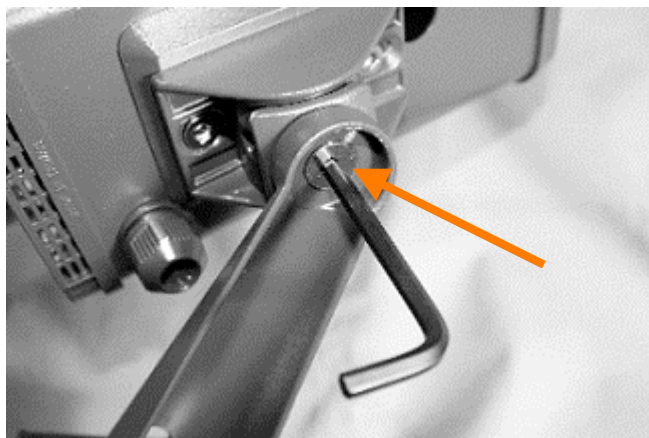

1. Verify Aiming by Viewing “User Interface”

A. Access the Eye Trax web site: www.eyetrax.net

B. Login using the username and password established during unit purchase:

Step 1

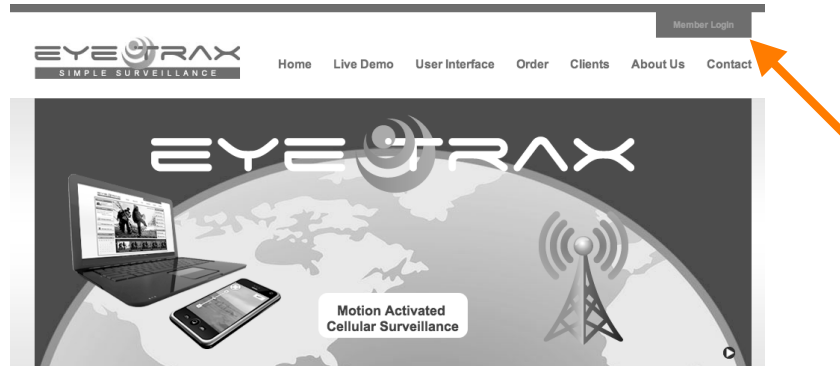

Step 2

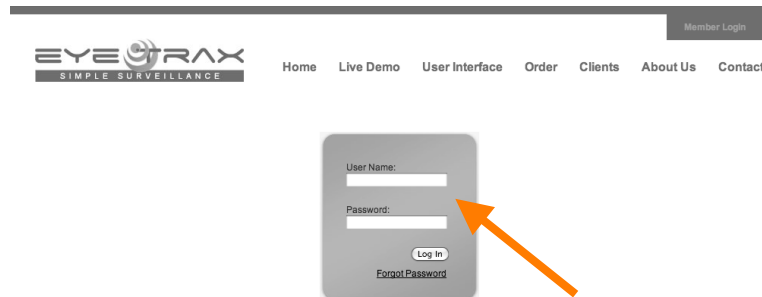

C. Click on picture on “Camera Console” page

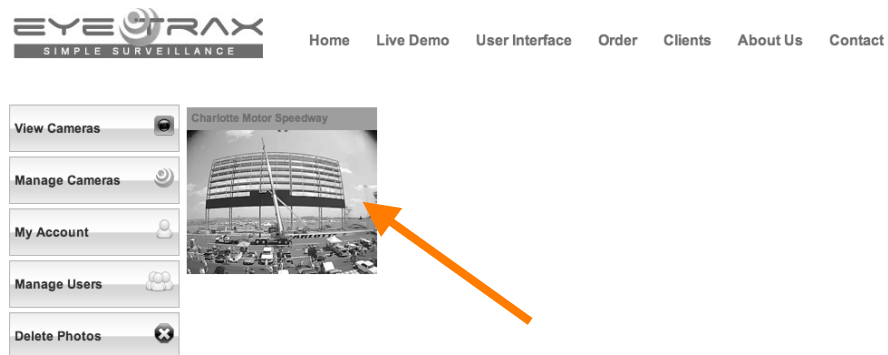

- D. Verify position of camera by viewing picture in “User Interface”. Make adjustments if needed and click “Instant Picture” button to verify new adjustments.



- E. For more detailed information on the “User Interface” and “Camera Console” see User Interface instructions.

Camera is Not Sending Pictures

1. Camera is not sending pictures:

- a. Verify there is power to the camera by looking through the glass on the housing towards the location where the antenna comes through the housing. Verify that there is a solid steady green light.
- b. Verify cellular connectivity by looking through the glass on the housing towards the location where the antenna comes through the housing. Verify the status light blinking:
 - 1 blink per second = searching for network
 - 1 blink every three seconds = connected to network
- c. Verify that the correct commands have been sent to the camera in the “User Interface” by sending the commands again.
- d. Power cycle camera by turning it off for 30 seconds and then back on. This will help re-sync the cellular modem with the network.

Camera is Sending Too Many Pictures

1. Camera is sending too many pictures with motion sensor turned on:

- a. Verify settings on the motion sensor (see: Chapter 2, Page 6).
- b. The camera may be caught in a loop due to weak cellular signal causing the motion sensor to trigger over and over again. Change the motion detector setting on the “User Interface” to motion every 5 minutes.

Motion Detector is Not Picking Up Motion

1. Motion detector is not picking up motion:

- a. Verify settings on the motion sensor (see: Chapter 2, Page 6).
- b. Verify the red light is bright red on the motion sensor.
- c. Verify the motion sensor is not obstructed in any way.

For “User Interface” instructions, see: User Interface Instructions.pdf on www.eyetrax.net

For technical support, call (800) 594-4157

 Eye Trax Inc.
© 2012 Eye Trax Inc. All rights reserved.